

Step 15

Ensure that batteries are not in backwards or motor will not operate. Place the battery cartridge into the headrail. *Be certain the cartridge is lying flat, and does not interfere with the lift cord operation.*

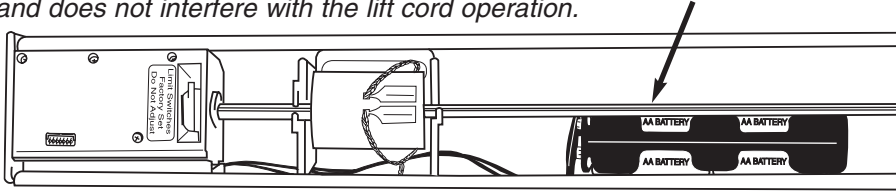

Step 16

Plug satellite eye into top of motor. Connector will plug in easily. **Do Not force.**

If connector does not plug in easily, reverse the direction (it may be backwards).

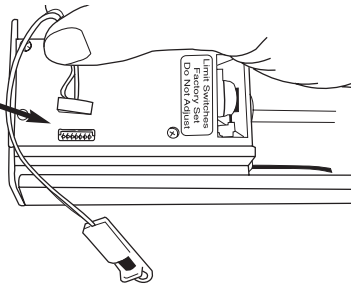

Step 17

Install blind into window following manufacturers instructions.

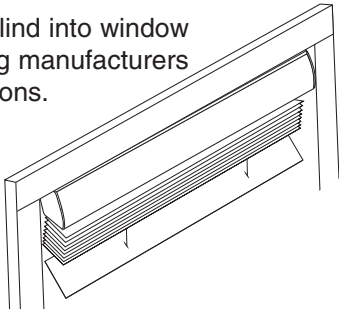

Step 18

Place double stick foam tape on the back of the satellite eye. Snap off screw port and attach satellite eye to the front of the headrail, or desired location. *Satellite eye must be visible to operate.*

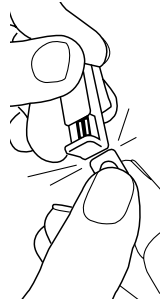

Step 19

Point the remote control at the eye and rotate the blind from a closed to closed position.

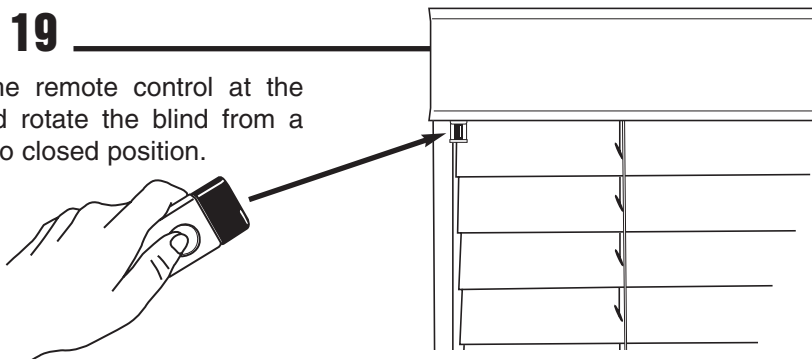

Harmonic Design, Inc.

● Somfy international

Retrofit Fabrication Instructions

2" Horizontal Tilt System

Kit consists of

- A) Motor
- B) 4 AA battery cartridge
- C) 5" Satellite eye
- D) Tilt rod adapters
- E) Optional 2 X 2 headrail adapter
- F) Measuring tool

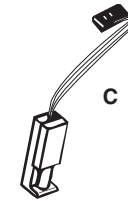

The motor accommodates three different styles of tilt rod. Choose the correct adapter to accommodate your tilt rod style. *No adapter is necessary for 1/4" square tilt rods.*

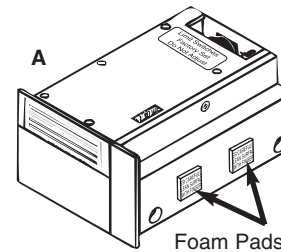

Motor is factory set. **Do Not** make any adjustments to limit stops. **Do Not** activate or connect power to the motor until the fabrication process is complete.

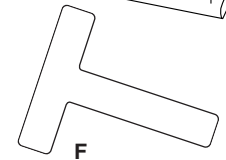
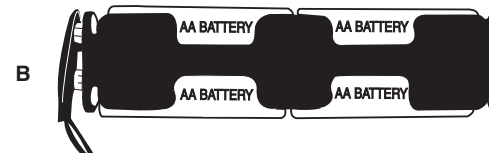
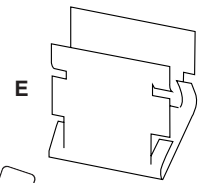

Tools required



Dremel tool with cutoff wheel or Hack saw

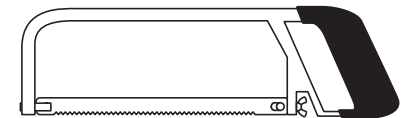

Hammer

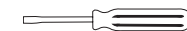

Flathead Screwdriver

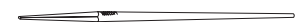

Rat tail file

2" Horizontal Blinds

Step 1

Place blind on a flat surface.

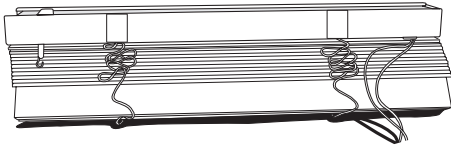

Step 2

Tap off both end caps.

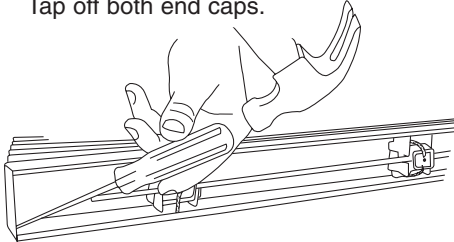

Step 3

Slide tilt rod out of wand or cord tilter and remove tilter.

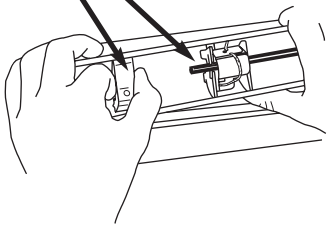

Step 4

Use measuring "T" to mark tilt rod with permanent marker. Tilt rod should be 2 1/2" shorter than the headrail.

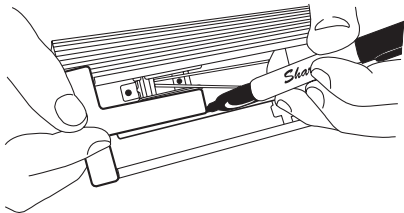

Step 5

Slide tilt rod out from headrail until mark clears headrail.

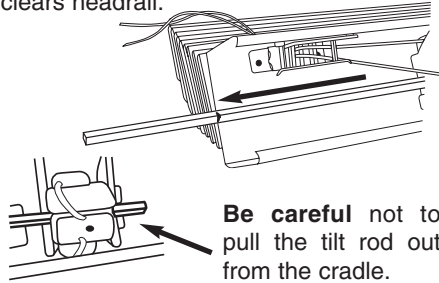

Step 6

Cut tilt rod using dremel tool or hack saw.

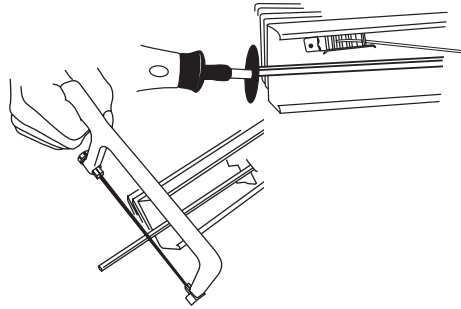

Step 7

File end of tilt rod to remove any rough edges.

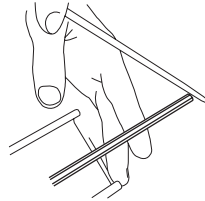

Step 8

Tap the appropriate adapter onto the end. Be certain the adapter is on completely.

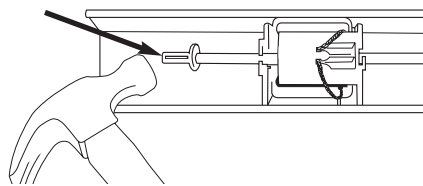

Step 9

With the blind in an **Open Horizontal Position** (the flat of the barrels facing up) slide the battery cable through the front of the cradle.

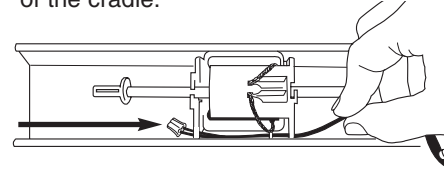

Step 10 2x2 Headrail Assembly

If using *Low Profile Headrail* go to **Step 11**. All others proceed to **Step 10**.

When using the 2x2 Headrail, you must use the headrail adapter. Note the two small notches on the front of the adapter.

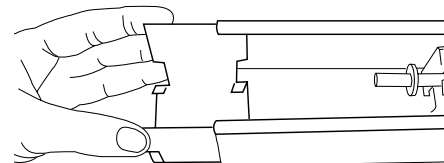
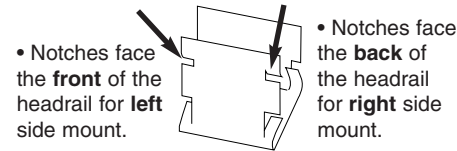

Slide the adapter into the headrail approximately 1/2 inch from the end of the headrail.

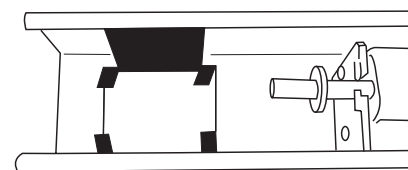

Adapter will fit snugly.

Step 11

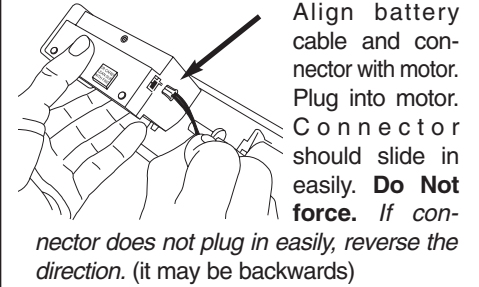

Step 12

Remove adhesive liner from foam pads. (Found attached to the front of motor). With top of motor tilted forward, snap motor into headrail.

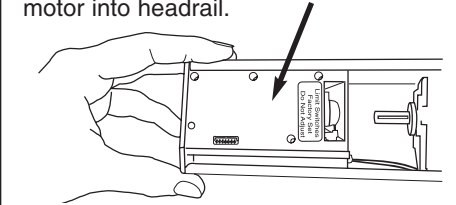

Step 13

Once motor is in place, slide the tilt rod into the motor. Again, be certain the blind is in an **Open Horizontal Position**. Failure to do so will cause the blind to operate incorrectly.

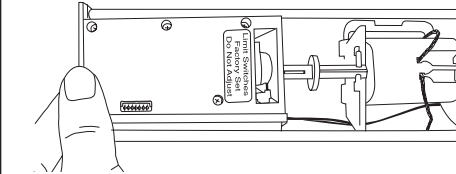

Step 14

Using **four AA** alkaline or lithium batteries, snap batteries into the battery cartridge. Connect the battery cartridge to the battery cable.

